

Wayne Township James Laughlin Order No 5592 Aug. 28<sup>th</sup> 1769.

|    | N.           | S      | E     | W      | M Dist.    | N Area      | S Area     |
|----|--------------|--------|-------|--------|------------|-------------|------------|
| 1  | S 39 E 39.0  | 26.42  | 21.40 | ---    | 349.46     | ---         | 9232.7332  |
| 2  | S 77 E 87.0  | 19.57  | 84.75 | ---    | 425.57     | ---         | 8916.2877  |
| 3  | N 58 E 12.5  | 9.27   | 14.84 | ---    | 520.36     | 5146.7040   | ---        |
| 4  | S 14 E 72.0  | ---    | 69.86 | 17.40  | 571.04     | ---         | 11038.5584 |
| 5  | S 24 W 106.0 | ---    | 90.84 | ---    | 528.56     | ---         | 54395.0280 |
| 6  | S 26 W 98.0  | ---    | 86.53 | ---    | 478.58     | ---         | 40887.1556 |
| 7  | N 64 W 237.2 | 103.99 | ---   | 213.24 | 200.00     | 22174.8276  | ---        |
| 8  | N 30 E 28.0  | 24.25  | 14.00 | ---    | 14.00      | 339.5000    | ---        |
| 9  | N 38 E 122.0 | 96.14  | 75.07 | ---    | 703.07     | 9909.1498   | ---        |
| 10 | N 41 W 3.0   | 6.79   | ---   | 5.90   | 179.14     | 1169.5096   | ---        |
| 11 | N 54 E 100.0 | 58.78  | 80.85 | ---    | 166.34     | 14530.4160  | ---        |
|    |              |        |       |        | 249.20     |             |            |
|    |              |        |       |        | 328.06     |             |            |
|    |              |        |       |        | 53270.1070 | 154463.7629 |            |

298<sup>a</sup> 85 perches & allowance

53270.1070  
 53270.1070  
 101199.6559  
 1696 50599 82795 (298<sup>a</sup>)  
 3392  
 16679  
 15264  
 14158  
 13568  
 106 5900 55 pr  
 530  
 600  
 530

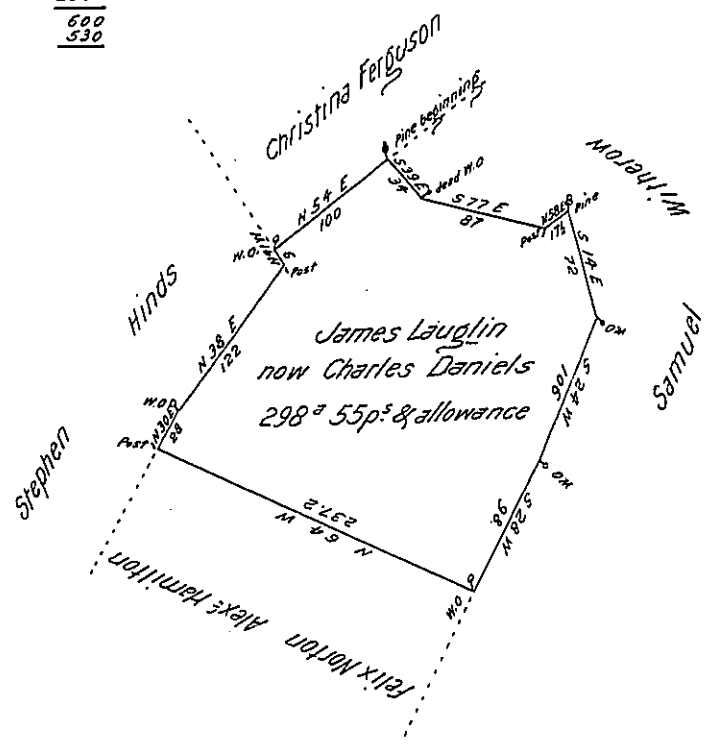

Surveyed by W<sup>m</sup> M. Clay May 10<sup>th</sup> 1778 Resurveyed & corrected <sup>or altered</sup> by W<sup>m</sup> Harris April 29<sup>th</sup> 1801 & returned Feb. 6<sup>th</sup> 1805 for 296<sup>a</sup> 102p<sup>a</sup> & allowance. Examined & corrected Nov. 6<sup>th</sup> 1852 & found to contain 298<sup>a</sup> 55p<sup>a</sup> & allowance of 6 per Cent & - = To be patented

John R Weeks C.S

To J. Porter Brawley Esq  
 Surveyor General of Penn<sup>a</sup>

24.25 349.46  
 14 26.42  
 339.50 694.92  
 133784  
 209676  
 69892  
 92327332  
 455.61  
 19.57  
 318927  
 227805  
 410049  
 45561  
 8916.2877  
 555.20  
 9.27  
 388640  
 111040  
 499680  
 5146.7040  
 587.44  
 69.86  
 352464  
 469952  
 528696  
 352464  
 41038.5584  
 561.70  
 96.84  
 224680  
 449360  
 337020  
 505530  
 54395.0280  
 478.52  
 86.53  
 141756  
 236260  
 283512  
 378016  
 40887.1556  
 213.24  
 103.99  
 191916  
 191916  
 63972  
 213240  
 221748276  
 103.07  
 96.14  
 41228  
 10307  
 61842  
 92763  
 9909.1498  
 172.24  
 6.79  
 155016  
 120568  
 103344  
 1169.5096  
 247.20  
 58.78  
 197760  
 173040  
 197760  
 123600  
 14530.4160

IN TESTIMONY that the above is a copy of the original remaining on file in the Department of Internal Affairs of Pennsylvania, made conformably to an Act of Assembly approved the 16th day of February, 1833, I have herunto set my Hand and caused the Seal of said Department to be affixed at Harrisburg, this

thirty-first day of August 1905.

Secretary of Internal Affairs.